

LOT 37D

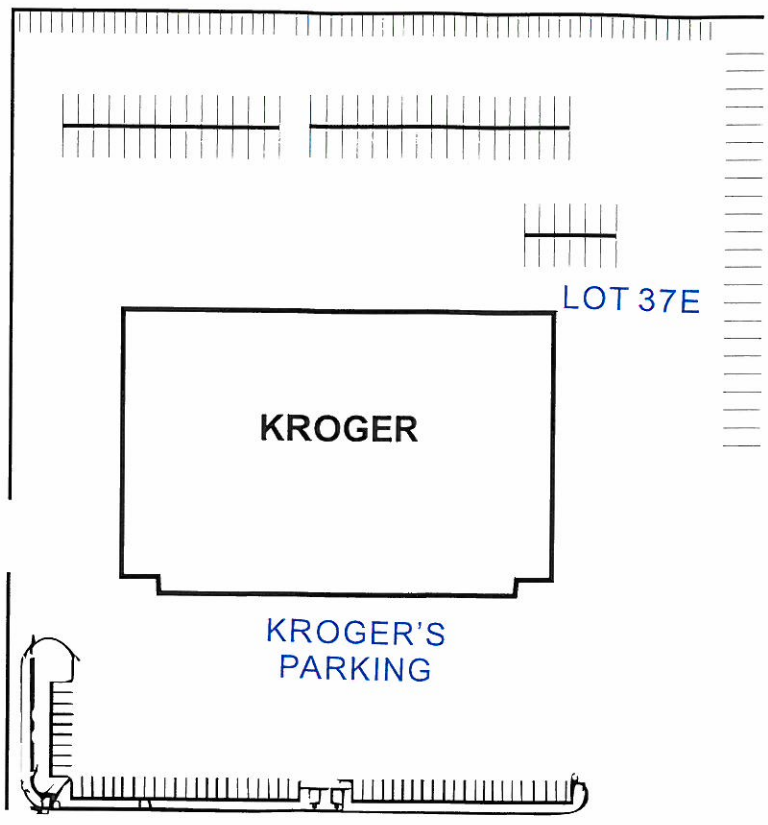

LOT 37E

KROGER

KROGER'S  
PARKING

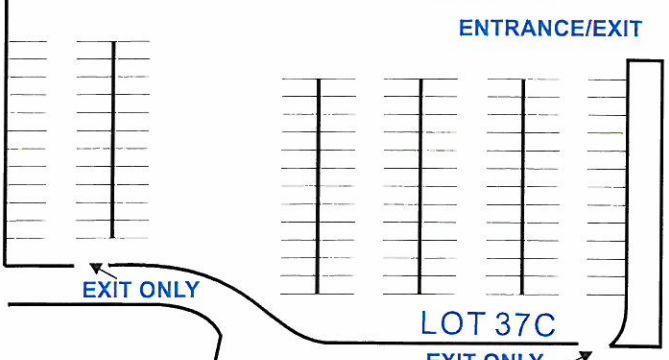

ENTRANCE/EXIT

EXIT ONLY

LOT 37C  
EXIT ONLY

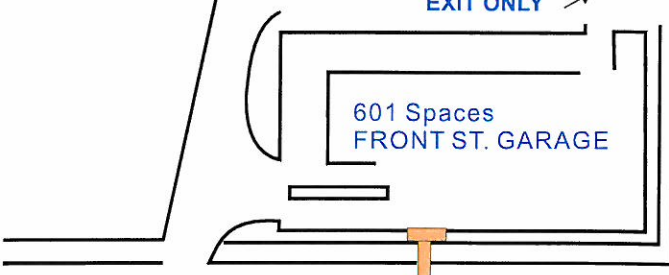

601 Spaces  
FRONT ST. GARAGE

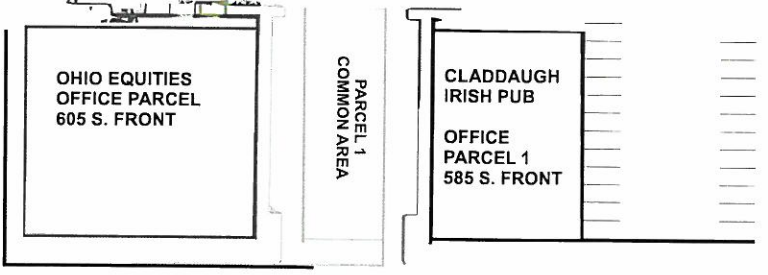

OHIO EQUITIES  
OFFICE PARCEL  
605 S. FRONT

PARCEL 1  
COMMON AREA

CLADDAUGH  
IRISH PUB  
OFFICE  
PARCEL 1  
585 S. FRONT

SOUTH FRONT STREET

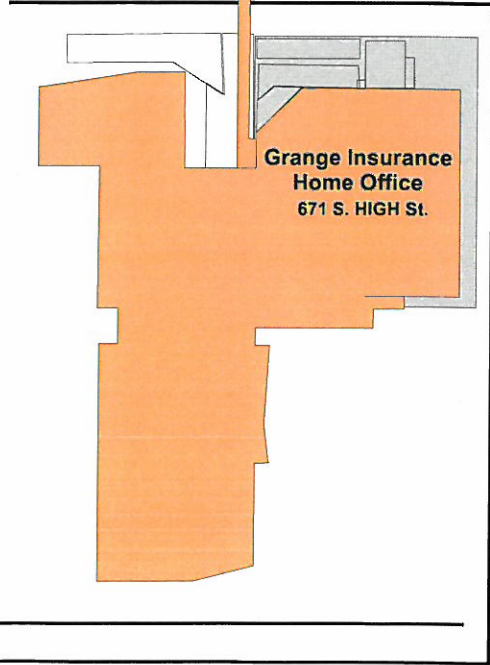

Grange Insurance  
Home Office  
671 S. HIGH St.

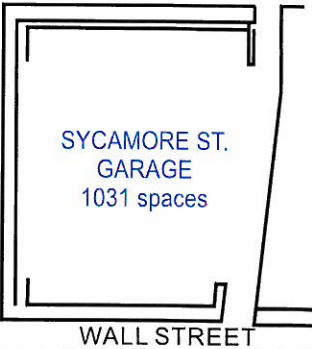

SYCAMORE ST.  
GARAGE  
1031 spaces

SYCAMORE ST.

WALL STREET

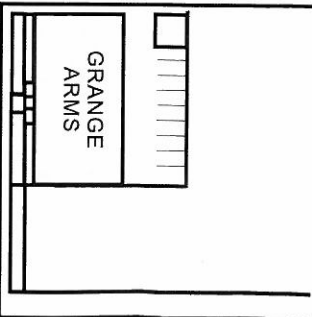

GRANGE  
ARMS



SOUTH HIGH STREET